

Single-phase line reactors for harmonic filtering with bimetal over-temperature protection, in IP20 enclosure and resin filled



Technical characteristics

| | |
|---------------------|-------------------------------|
| Rated current | 31,5 A |
| Motor rating | 4 kW / 5,5 CV |
| Line voltage | 220 - 260 V |
| Reactor | 0,697 mH (50 Hz) |
| Voltage drop | 3% (50 Hz) |
| Frequency | 50/60 Hz |
| Protection degree | IP-20 |
| Thermal protection | Thermal protection (NC) 120°C |
| Cooling | ANAN |
| Ambient temperature | 45°C |
| Temperature rise | Class B - 130°C |
| Insulation | Class H - 180°C |
| Windings | Class HC - 200 °C |
| Test voltage | 3 kV (1 min, 50 Hz) |
| Standards | IEC/EN/UNE-EN 60076-6, CE |
| Mounting | Screws |
| Weight | 3,2 kg |

Electric scheme

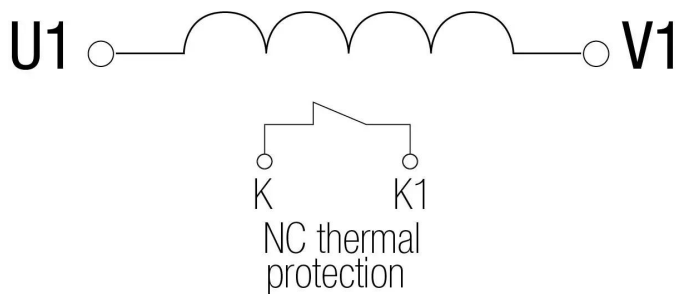

Dimensions

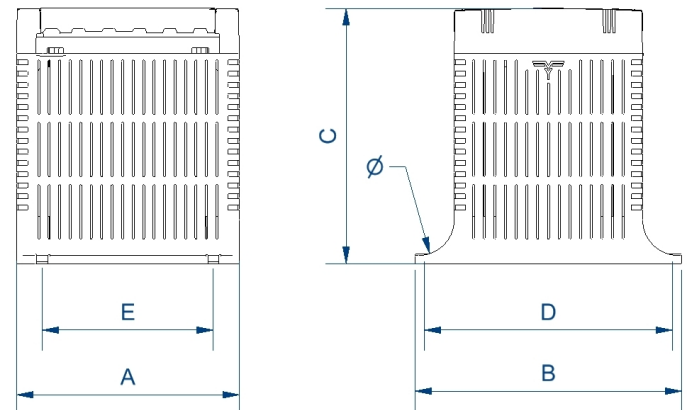

Dimensions (AxBxCxDxE): 136x162x156x146x104 mm 6Ø

Features

Reactor

Advantages of resin technology:

- Protection against corrosive environments
- Protection against high vibration levels
- Protection against electrodynamic efforts
- Reduction of noise level
- Increase of product's lifespan

IP-20 enclosure in last generation V-0 fireproof metallic polymer box according to UL94

Safety class I, convertible in class II

Includes thermal protection against overtemperatures

Possibility of tailor-made manufacturing

Technical remarks about the use of line reactors:

- Reduction of the current harmonics generated by the equipment, reducing current consumption and improving power factor
- Reduction of the peak factor of the current wave, increasing equipment's lifespan
- Attenuation of the microcuts of the feeding voltage produced by the converter, source of the bad functioning of computers, robots and other equipments

Applications

- Single-phase low rating installations where harmonic filtering is required, such as those with non-linear loads, rectifiers, single-phase frequency converters, power supplies, etc.
- Environments with high humidity or corrosion, as well as vibrations and voltage peaks, due to the resin coating.

Downloads
