

# 1. Single phase rectifier transformers

PTR | TR | TRF FAMILY > TRC1.6

**POLYLUX**

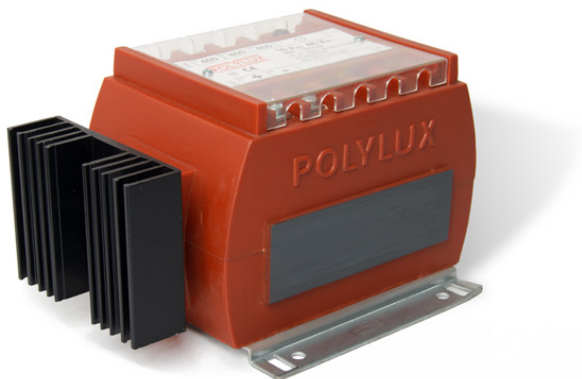

## Technical Characteristics

Rating	1,6 A <sub>dc</sub>
Input voltage	230 Vac
Output voltage	48 V <sub>dc</sub>
Output ripple	48%
Frequency	50/60 Hz
Protection degree	IP-20
Cooling	AN
Ambient temperature	25°C
Temperature rise	Class B
Insulation	Class B - 130°C
Windings	Class HC - 220°C
Leakage current	3 kV (1 min, 50 Hz) pri-sec 3 kV (1 min, 50 Hz) pri-earth 0,5 kV (1 min, 50 Hz) sec-earth
Standards	IEC/EN/UNE-EN 61204, CE
Mounting	Screws and DIN Rail
Weight	1,8 Kg
Dimensions	95x96x100xx mm 6Ø

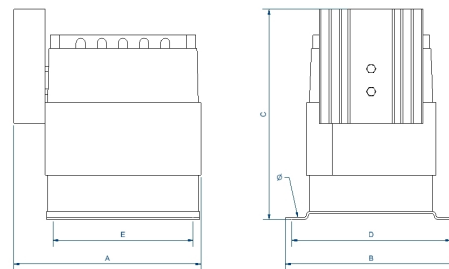

+ Info [www.polylux.com](http://www.polylux.com)

Productos equivalentes