

# 1. Three phase isolating transformers

TT FAMILY > TTE80

**POLYLUX**



## Features

Dry type resin cast transformer

Advantages of resin technology:

Protection against corrosive environments

Protection against high vibration levels

Protection against electrodynamic efforts

Reduction of noise level

Increase of product's lifespan

Safety class I

Includes lifting eyebolts from 6,3 kVA

Possibility of tailor-made manufacturing

## Technical Characteristics

Rating 80 kVA

Input voltage 400 V

Output voltage 400 V

Frequency 50/60 Hz

Connection group Yyn0

Protection degree IP-00

Cooling AN

Ambient temperature 40 °C

Temperature rise Class H

Insulation Class H - 180°C

Windings Class HC - 200 °C

Test voltage 3 kV (1 min, 50 Hz)

Standards IEC/EN/UNE-EN 60076, CE

Weight 490 kg

Dimensions (AxBxCxDxE) 750x550x898x460x472 mm 13Ø

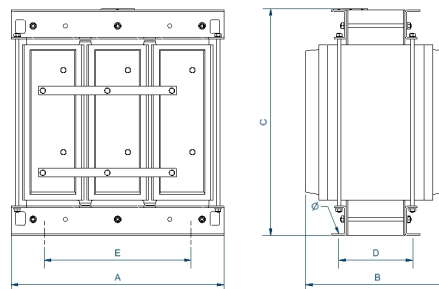

+ Info [www.polylux.com](http://www.polylux.com)

Productos equivalentes