

Primary Connexion

Secondary Connexion

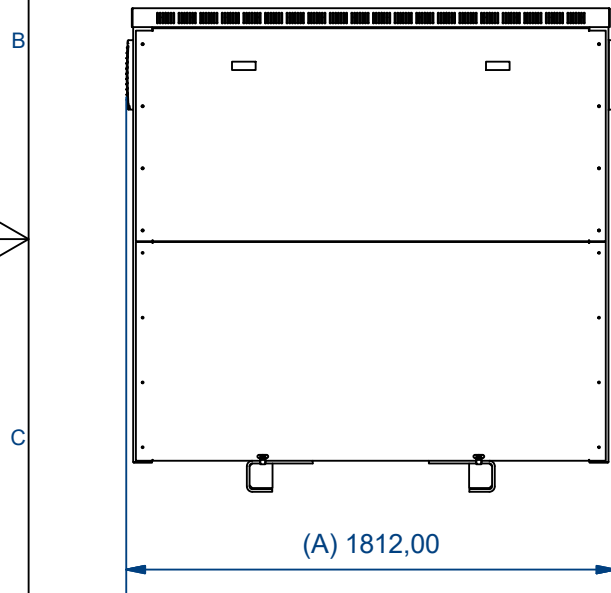
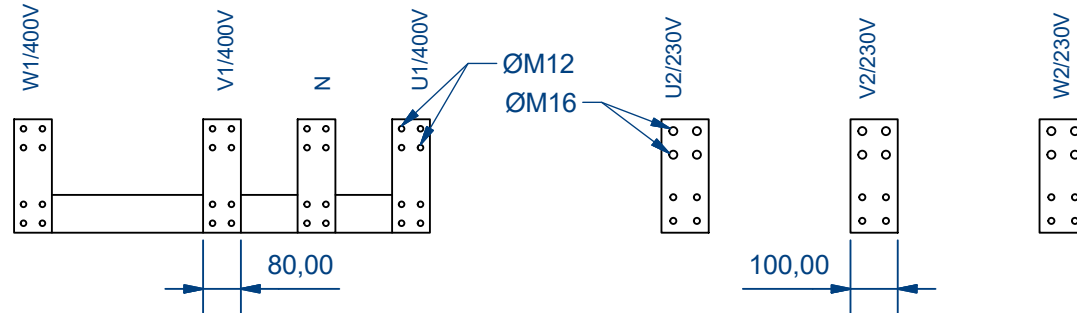

AUTW1000 Enclosure (1/35)

AUTW1000 Transformer (1/25)

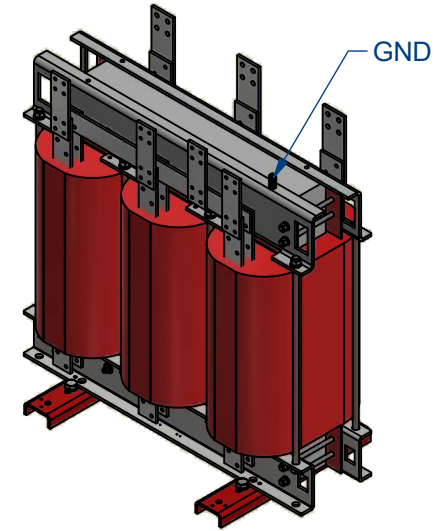
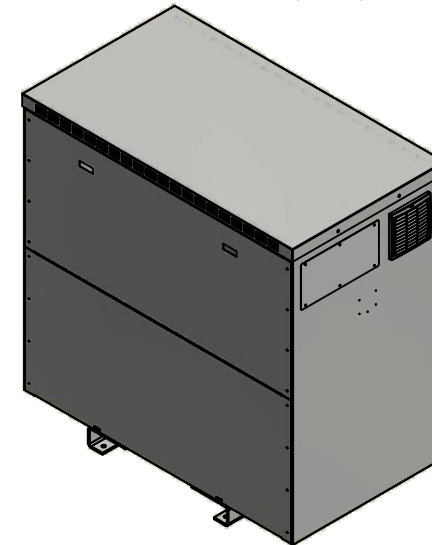
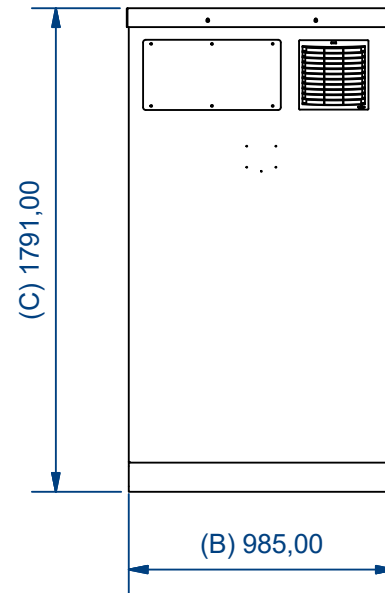

YN0

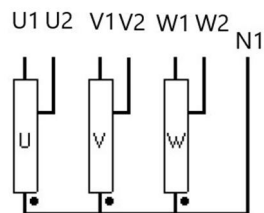

Characteristics									
IP	Vector Group	Rated power	Voltage Pri.	In Pri.	Pri. Connection	Voltage Sec.	In Sec.	Sec. Connection	Ground connection
23	YN0	1000 kVA	400 V	1443,4 A	80X10 mm Al Plate Ø M12	230 V	2510,2 A	100X10 mm Al Plate Ø M16	M12 Brass stud
Drawn by: OPS-03/01/2024		Modified by: -		Approved by: AMR-03/01/2024		Replaces:		Material: Generic	
						Surface treatment: N/D		Weight: 49.013 kg	
						Description: AUTW1000 Drawing		Valid:	
Drawing reference: PE.C.NOR.AUTW1000.V01				ERP reference: AUTW1000		Distributed to:		Scale: 1/28	
						Technical D.		Page: 1 / 1	
						Commercial D.		Customers	