

Connexion (2/3)

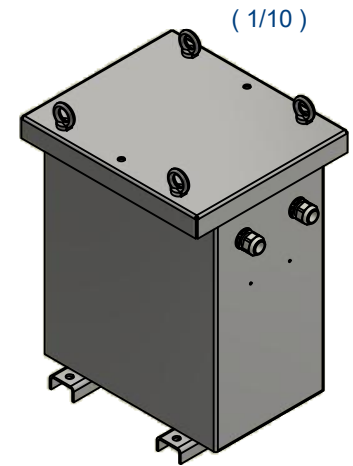

YN0

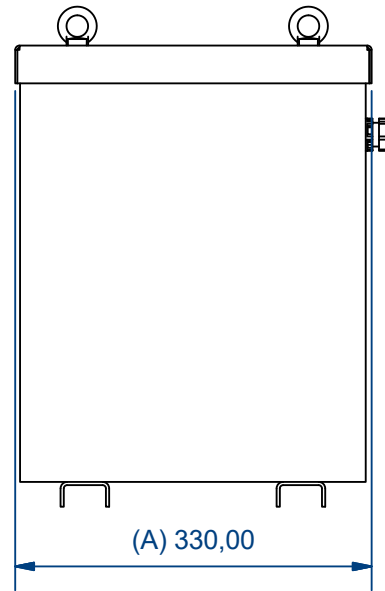
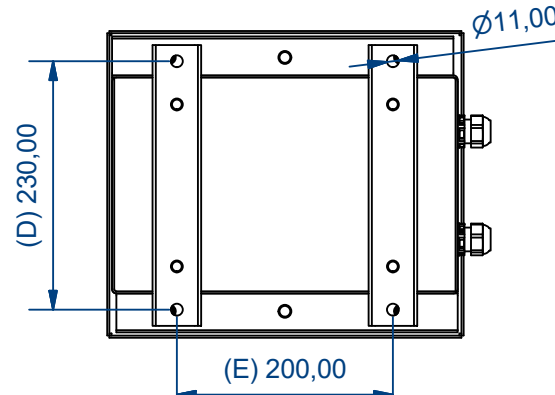
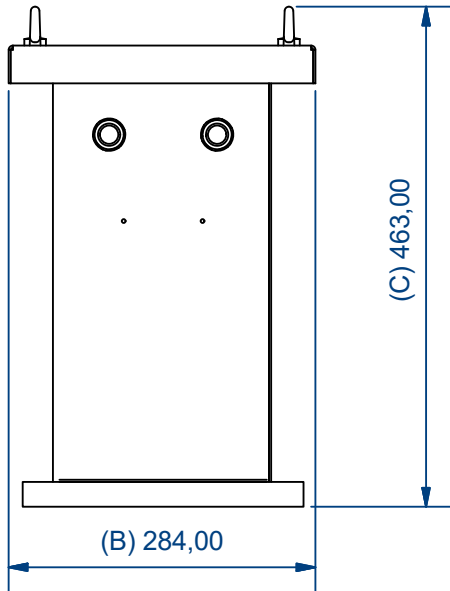
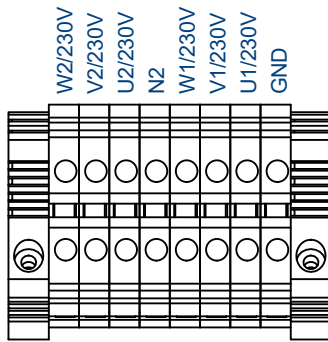
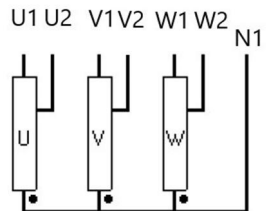

Characteristics									
IP	Vector Group	Rated power	Voltage Pri.	In Pri.	Pri. Connection	Voltage Sec.	In Sec.	Sec. Connection	Ground connection
54	YN0	3,15 kVA	400 V	4,54 A	Terminal wire up to 10 mm ²	230 V	7,90 A	Terminal wire up to 10 mm ²	Terminal wire up to 10 mm ²
Drawn by: OPS-03/01/2024		Modified by: -		Approved by: AMR-03/01/2024		Replaces:		Material:	
						Description: AUTZ3,15 Drawing		Units: mm	
						Drawing reference: PE.C.NOR.AUTZ3,15.V01		ERP reference: AUTZ3,15	
								Scale: 1/7	Page: 1 / 1