

Primary Connection

Secondary Connection

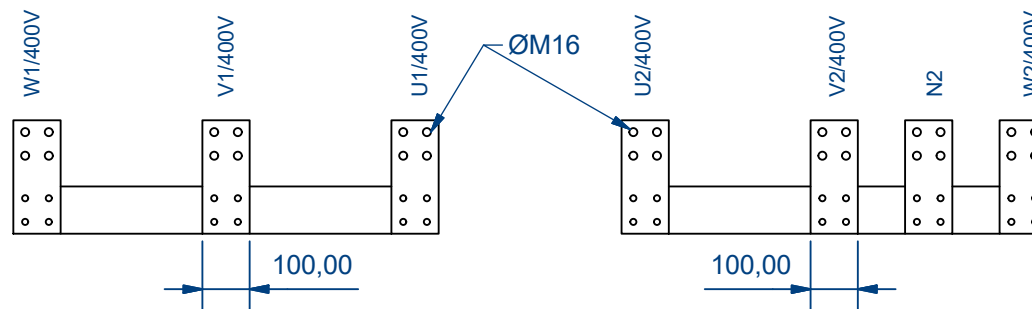

A

A

B

B

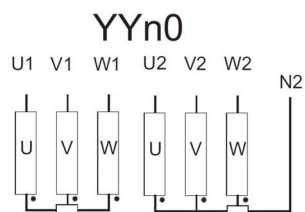
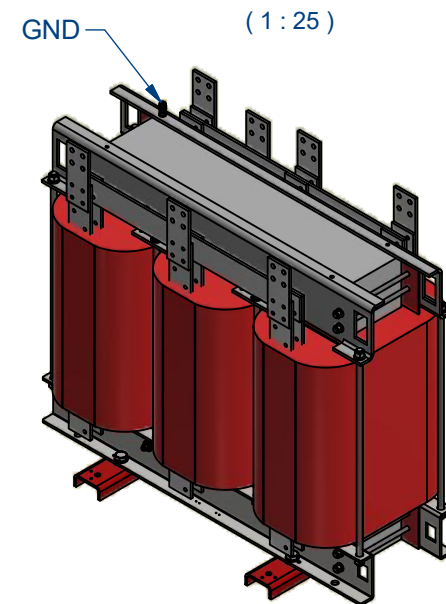
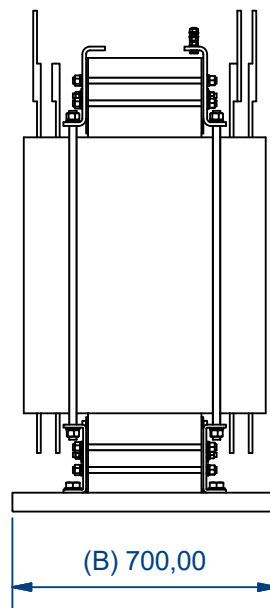
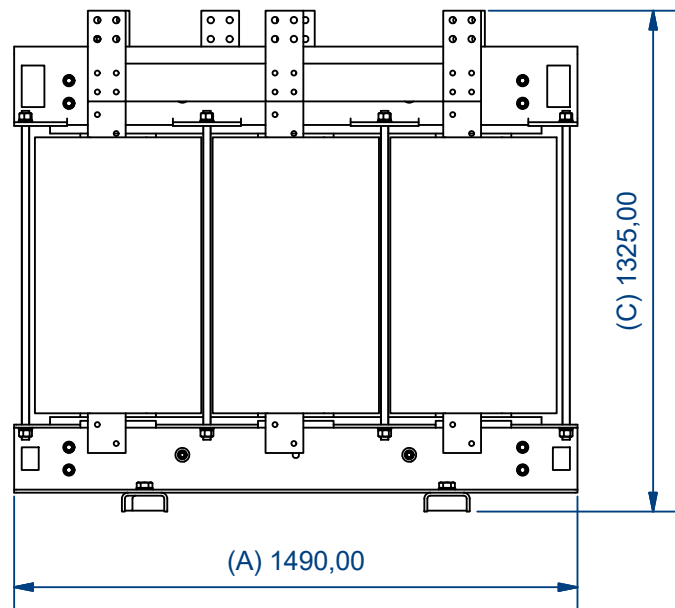

Characteristics											
IP	Vector Group	Rated power	Voltage Pri.	In Pri.	Pri. Connection	Voltage Sec.	In Sec.	Sec. Connection	Ground connection		
00	YYN0	1000 kVA	400 V	1443,38 A	100X10 mm Al Plate Ø M16	400 V	1443,38 A	100X10 mm Al Plate Ø M16	M12 Brass stud		
Drawn by: OPS-11/12/2023		Modified by: -		Approved by: AMR-11/12/2023		Replaces:		Material: Generic	Surface treatment: N/D	Weight: N/D	Valid:
<b>POLYLUX</b>						Description: TTX1000 Drawing				Units: mm	Directory:
						Drawing reference: PE.C.NOR.TTX1000.V01			ERP reference: TTX1000		Distributed to:

D

D

1

2

3

4

5

6

7

8