

Connexion (1 / 2)

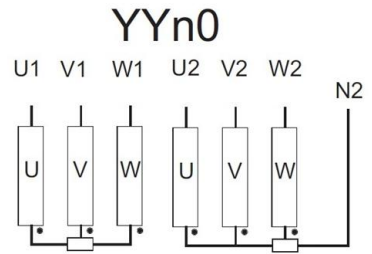
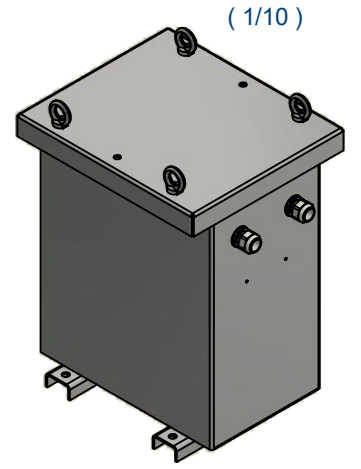
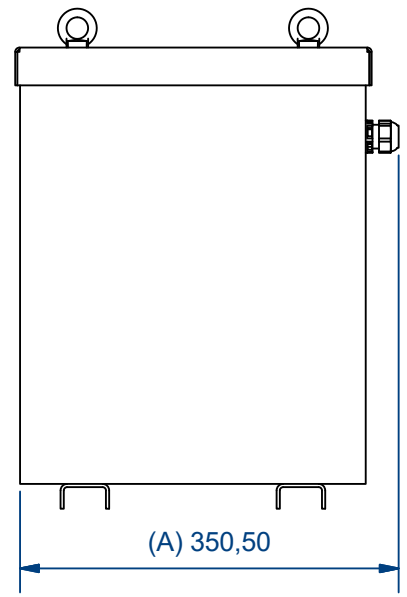
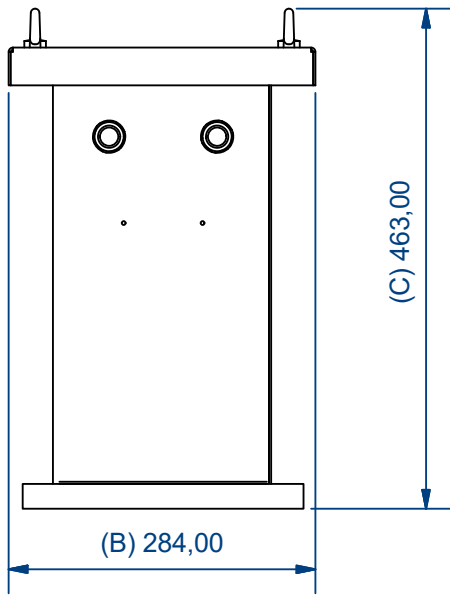
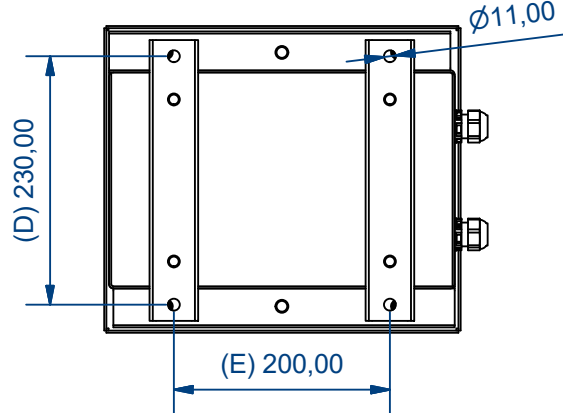

Characteristics											
IP	Vector Group	Rated power	Voltage Pri.	In Pri.	Pri. Connection	Voltage Sec.	In Sec.	Sec. Connection	Ground connection		
54	Yyn0	2 kVA	400 V	3.6A	Terminal wire up to 16 mm ²	400 V	3.6 A	Terminal wire up to 16 mm ²	Terminal wire up to 16 mm ²		
Drawn by: SB-07/02/2023		Modified by: -		Approved by: MMB-16/03/2023		Replaces: -		Material:			
								Surface treatment: N/D			
								Weight: N/D			
								Valid: Yes			
POLYLUX				Description: TTZ 2 Drawing				Units: mm		Directory:	
				Drawing reference: PE.C.NOR.TTZ2.V01		ERP reference: TTZ 2		Distributed to:		Technical D.	
						Commercial D.		Customers		Page: 1 / 1	